

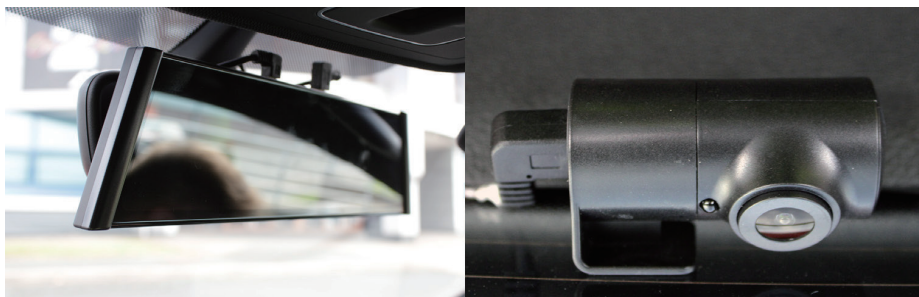

**CAM-KIT13**  
**CAM-KIT14**

**Clip-On Mirror Monitor DVR**  
with 1080p Front & Rear Camera  
Right-Hand Drive (13) / Left-Hand Drive (14)



## PRODUCT FEATURES

- Catch every moment with dual lens recording
- Clips onto rear-view mirror for a quick and easy installation
- GPS information included during playback
- ADAS (Advanced Driver-Assistance Systems) safety integration
- Records to SD card (maximum capacity 128GB) with loop functionality

### Monitor

- Clip-On Monitor with 9.88" Capacitive Touch Display
- 1920p x 1080p Resolution
- Simple, OEM-look Installation

### Reversing Camera

- 1080p Resolution
- 140° Wide Angle
- IP68 Waterproof
- 'Driving Mode' for rear-view mirror functionality

# Connects2Vision

## Prior to Installation

Read the manual prior to installation. Technical knowledge is necessary for installation. Please ensure you use the correct tools to avoid damage to the vehicle or product.

**Connects2 can not be held responsible for the installation of this product.**

## Technical Support

Connects2 want to provide a fast and suitable resolution should you encounter any technical issues. With this in mind, when contacting Connects2, try to provide as much Information as possible. This will speed up the process and help us to help you.

**Please use our dedicated online technical support centre: [support.connects2.com](http://support.connects2.com)**

## MONITOR OVERVIEW

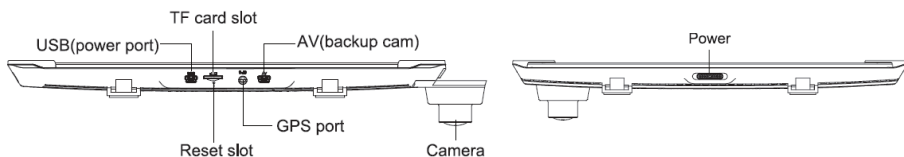





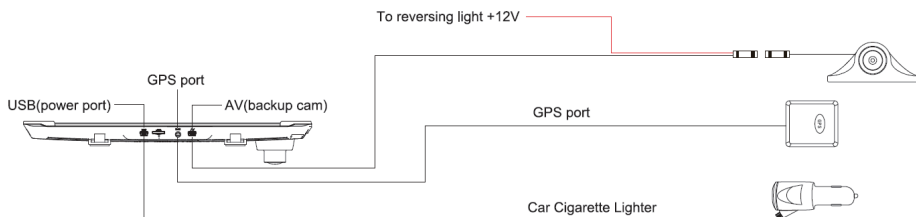

## KEY

- |         |                                                 |         |                                        |
|---------|-------------------------------------------------|---------|----------------------------------------|
| Power - | Enter screensaver (single press)                | GPS -   | Connect GPS antenna                    |
|         | Close screen (double press)                     | Reset - | Reset the product                      |
|         | Turn off monitor (press and hold for 3 seconds) | USB -   | Connect power cable (from vehicle 12V) |
| AV -    | Connect reversing camera                        |         |                                        |

## WIRING OVERVIEW



## TOUCHSCREEN HUD

-  **Power Button:** Long touch - close the LCD, short touch - switch to driving mode
-  **Menu & Settings:** Enter menu (Note: recording must be paused)
-  **Video/Photo:** View recorded videos and saved photos
-  **Start/Stop Video:** Begin or stop recording video
-  **Rear/Front View:** Switch between rear and front camera view
-  **Photo:** Take a screenshot
-  **Emergency Lock:** Save as an 'emergency video', protected from being recorded over by loop functionality



## MENU NAVIGATION

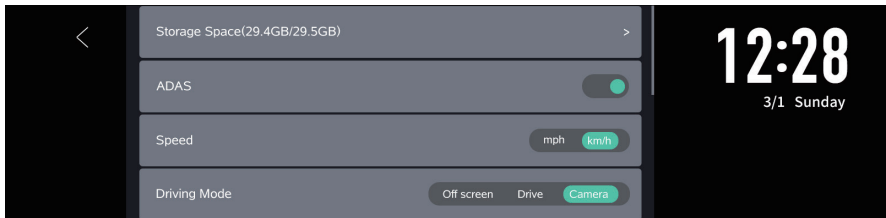

**Storage Space:** Display total memory/available memory. Select to enter SD Card format menu

**ADAS:** Turn lane departure warnings on or off

**Speed Mode:** Toggle between mph and km/h

**Driving Mode:** Toggle on to display rear-view image on the mirror by default when driving

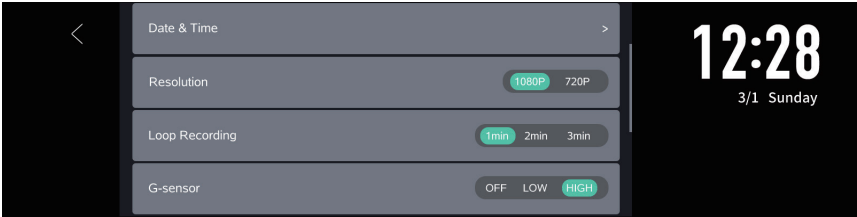

- Date & Time:** Set date and time of device
- Resolution:** Toggle resolution between 1080p and 720p
- Loop Recording:** Set to 1, 2 or 3 minutes
- G-Sensor:** Set to low or high sensitivity, or turn the feature off

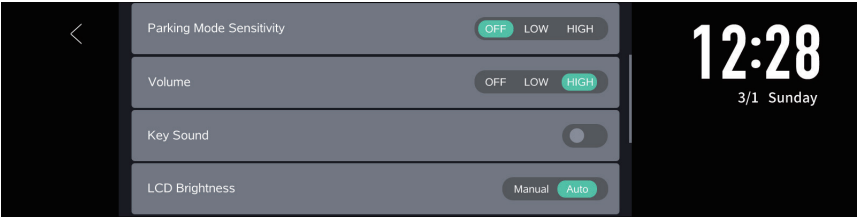

- Parking Mode Sensitivity:** Set to low or high sensitivity, or turn the feature off
- Volume:** Set volume level low or high, or turn off completely
- Key Sound:** Turn key sound on or off
- LCD Brightness:** Set to manual or auto



- Sound Record:** Turn audio recording on or off
- Rear camera mirror:** Turn rear camera mirror on or off
- Language:** Select device language
- Parking Line:** Turn reversing camera parking guidelines on or off



- GPS Info:** Display GPS signal strength
- About Car DVR:** Display DVR information
- Reset Setup:** Restore settings to factory defaults

## QUICK FUNCTIONALITY GUIDE

- **To turn the monitor on**

Connect the car charger to automatically power on the monitor. Alternatively, press the monitor power button if powered by the built-in battery.

- **To turn the monitor off**

Press and hold the monitor power button for 3 seconds. The monitor will also power off if the built-in battery drains to empty.

- **Activating advanced driver-assistance system (ADAS)**

Can be toggled off and on in the settings menus.

- **Activating driving mode**

Can be toggled off and on in the settings menus.

- **To view/playback photos and videos**

Press Video/Photo Playback icon on the Touchscreen HUD.

- **To delete/lock files**

When viewing files in playback mode, they can be deleted or locked (locking a file saves it as an 'SOS File' which protects it from being deleted or overridden by loop functionality)

- **To change date and time**

Can be set from the Date & Time menu. Time can be set automatically using GPS or set manually.

- **To format SD card**

Select 'Storage Space' option in settings menu. Then select 'Format SD Card' and press confirm the action to format storage.

## INSTALLATION

1. Attach the monitor to the OEM rearview mirror with the included buckle straps
2. Connect the car charger to the vehicle's 12V port and to the monitor. Note: the cable can be installed behind the side panels, A pillar and roof liner for a discreet installation
3. The reversing camera can be installed into a suitable location in the bumper, or above the license plate. See below:

### License Plate Installation

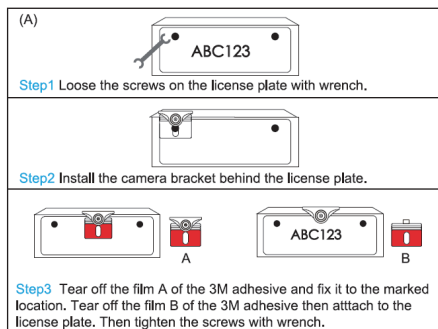

### Bumper Installation

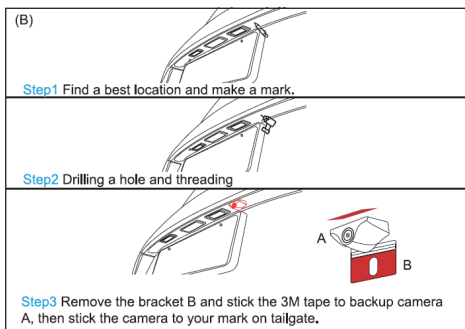

## CAMERA WIRING

1. Connect the red wire to the reverse light (+)
2. Open the inner plastic panel and remove it from the hatch or tailgate
3. Carefully strip back a portion of the red wire, find the reverse light power wires and connect the red wire of the video cable with the reverse wire +
4. Connect the 5pin camera wire to the video cable



## ROUTING

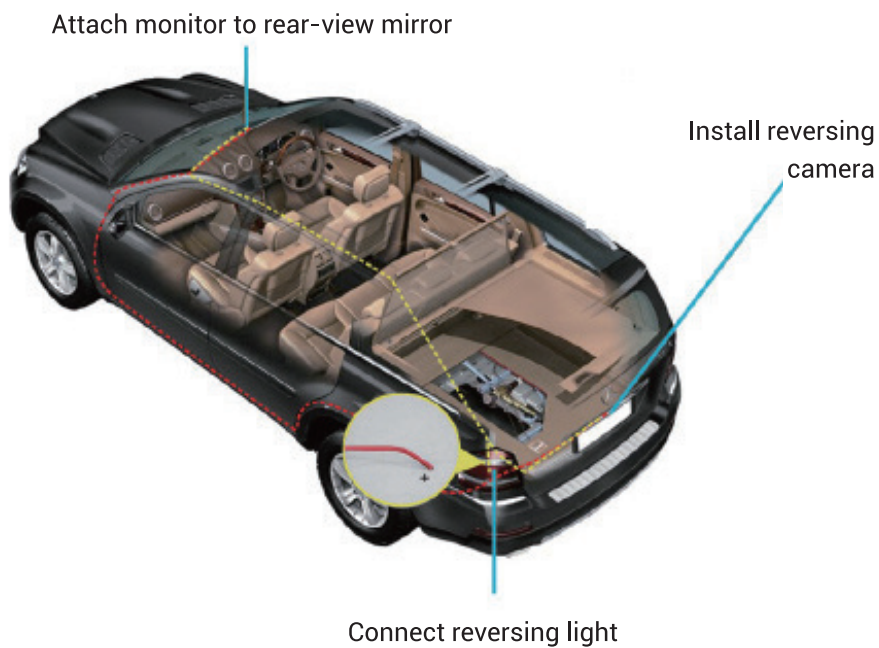

## NOTES

[illegible]