

**APPLICATIONS**  
**Toyota Highlander**  
**2008-2009**  
**NON-NAV MODELS ONLY**

**CT23TY08**

**KIT FEATURES**

- DIN Radio Provision with Pocket
- ISO Mount Radio Provision with Pocket
- Double DIN Radio Provision
- Stacked ISO Mount Units Provision



**KIT COMPONENTS**

- A) Radio Housing • B) ISO Brackets • C) ISO Trim Plate • D) Double DIN Brackets
- E) Double DIN/Stacked ISO Trim Plate • F) Snap in Pocket • G) Radio Housing Brackets

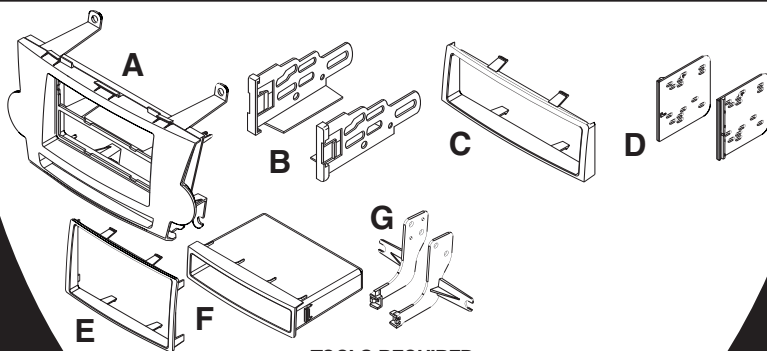

**TOOLS REQUIRED:**

- Small Flat Blade Screwdriver/ Panel Removal Tool
- Phillips Screwdriver • Socket Set



## **TABLE OF CONTENTS**

### **Dash Disassembly**

- Toyota Highlander 2008 -2009.....	1,2
-------------------------------------	-----

<b><u>Kit Preparation</u></b> .....	3
-------------------------------------	---

### **Kit Assembly**

- DIN Radio Provision with Pocket .....	4
---	---

- ISO Mount Radio Provision with Pocket.....	5
--	---

- Double DIN Radio Provision .....	6
------------------------------------	---

- Stacked ISO Mount Units Provision .....	6
---	---

<b><u>Final Assembly</u></b> .....	7
------------------------------------	---

#### **\*Note:**

**Refer also to the instructions included with the aftermarket radio.**

## **TOYOTA HIGHLANDER 2008-2009**

- 1** Disconnect the negative battery terminal to prevent an accidental short circuit.
- 2** Unclip and remove the a/c vent panel. (Figure A)
- 3** Unclip the trim panel containing the climate controls and pocket. Unplug the climate controls and remove the trim panel. (Figure B)
- 4** Remove (4) 10 MM bolts securing the radio assembly. Unplug and remove the radio assembly. (Figure C)

*Continued on page 2*

**A**

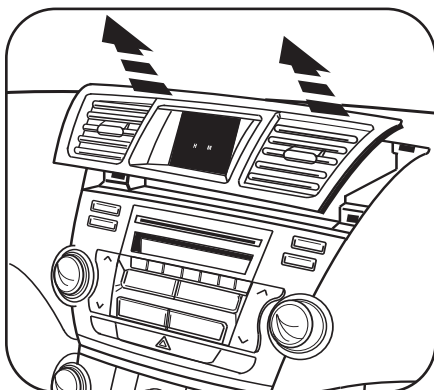

**B**

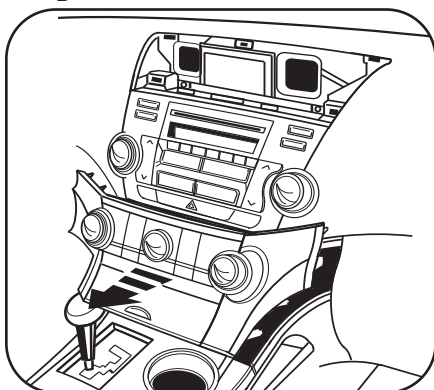

**C**

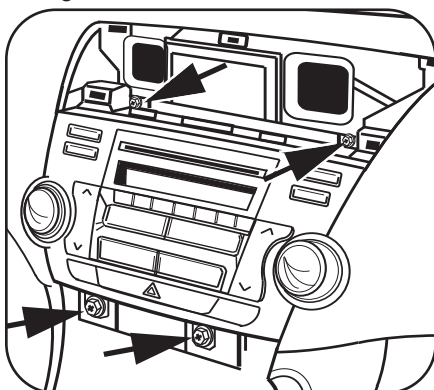

## **TOYOTA HIGHLANDER 2008-2009**

- 5** Remove the (2) Phillips screws securing the clock/display then remove the clock/display from the radio assembly.  
(Retain the screws and clock/display for re-use during kit preparation.)  
(Figure D)

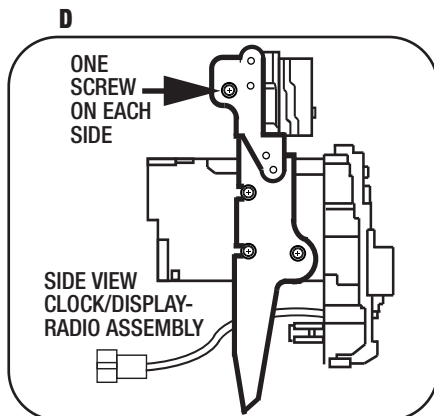

- 6** Unclip and remove the hazard switch assembly from radio assembly.  
(Retain the hazard switch assembly for re-use during kit preparation.)  
(Figure E)

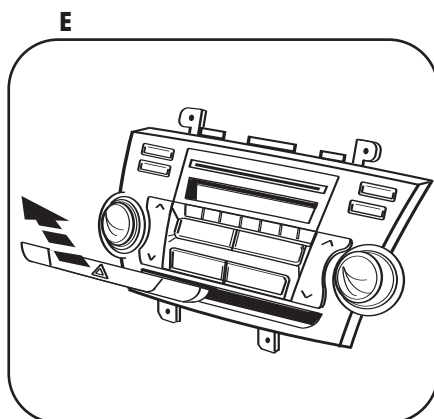

- 7** Remove (4) spring clips from the back of the radio. (Retain the spring clips for re-use during kit preparation.)  
(Figure F)

*Continue to kit preparation*

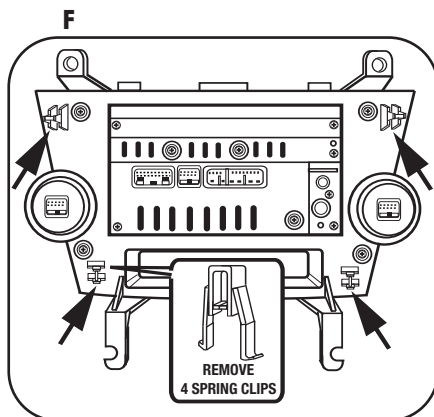

## **TOYOTA HIGHLANDER 2008-2009**

- 1 Attach the radio housing brackets to the radio housing. **Note:** Make sure that the leg on the bracket is on the outside of the leg on the radio housing. (Figure A)
- 2 Attach the clock/display to the brackets/radio housing assembly using the factory hardware. (Figure B)
- 3 Snap the hazard switch assembly into the radio housing. (Figure C)
- 4 Attach the (4) spring clips to the back of the radio housing. (Figure D)

*Continue to kit assembly*

**A**

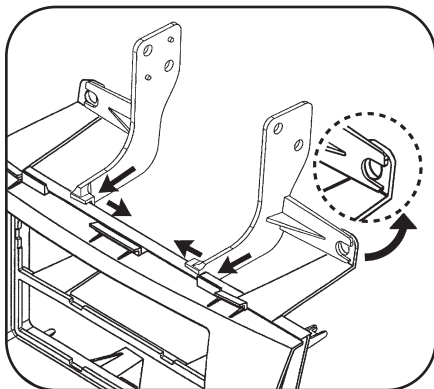

**B**

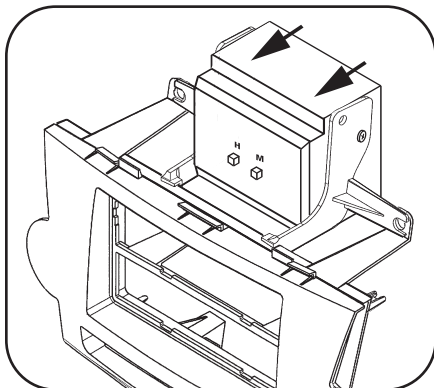

**C**

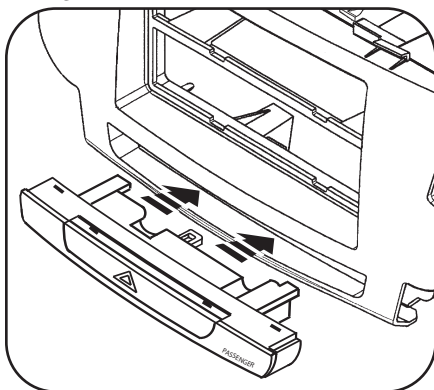

**D**

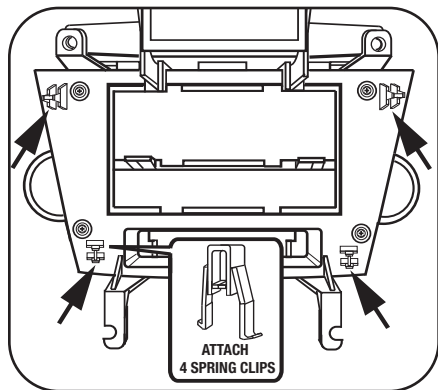

## DIN RADIO PROVISION WITH POCKET

*\*Note: Refer also to the instructions included with the aftermarket radio.*

- 1 Slide the DIN cage into the Radio Housing and secure by bending the metal locking tabs outward. (Figure A)
- 2 Slide the aftermarket radio into the DIN cage until it snaps into place. (Figure B)
- 3 Snap the pocket into the radio housing. (Figure C)

*Continue to final assembly.*

**A**

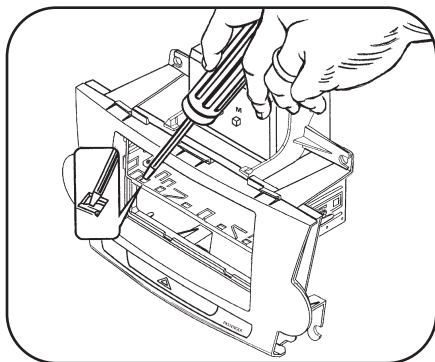

**B**

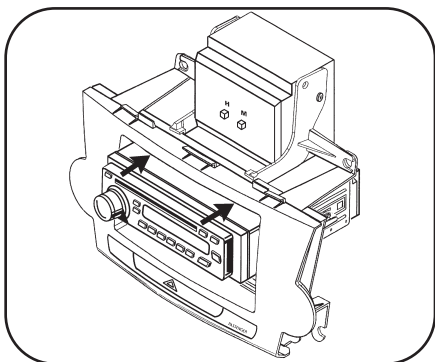

**C**

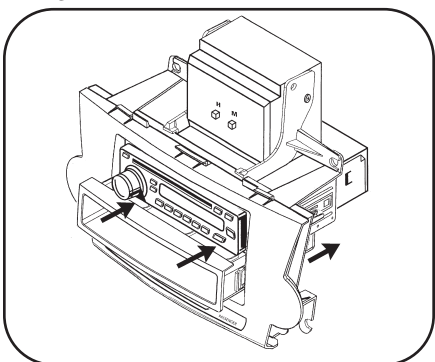

## ISO MOUNT RADIO PROVISION WITH POCKET

***\*Note: Refer also to the instructions included with the aftermarket radio.***

- 1** Mount the ISO Brackets to the radio using the screws supplied with the radio. (Figure A)
- 2** Slide the radio into the radio housing until it snaps into place. (Figure B)
- 3** Snap the ISO Trim Plate onto the front of the Radio Housing. (Figure B)
- 4** Snap the Pocket into the Radio Housing. (Figure C)

*Continue to final assembly.*

**A**

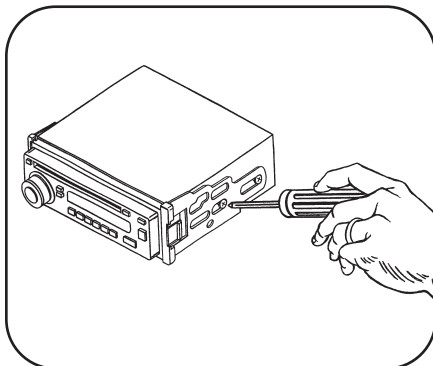

**B**

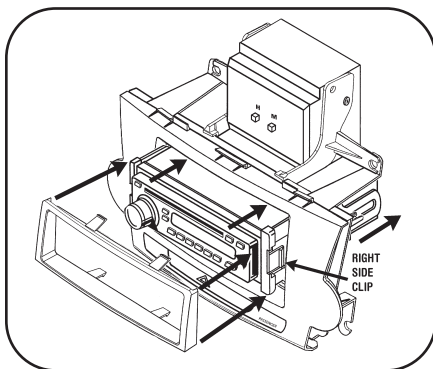

**C**

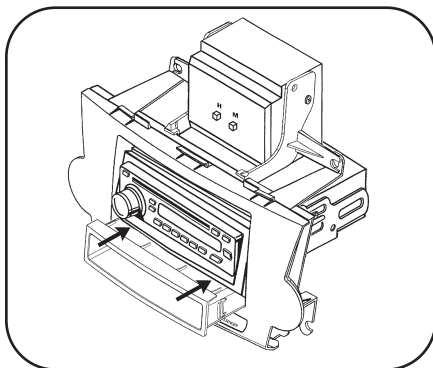

## DOUBLE DIN OR STACKED ISO MOUNT UNITS PROVISION

***\*Note:** Refer also to the instructions included with the aftermarket radio.*

- 1** Cut and remove the center bar from the Radio Housing. (Figure A)
- 2** Snap the Double DIN brackets to the inside edge of the Radio Housing. (Figure B)
- 3** Slide the Double DIN or stacked ISO mount units into the bracket/radio housing assembly then secure it to the assembly using the screws supplied with the units. (Figure C)
- 4** Snap the Double DIN/Stacked ISO Trim Plate onto the front of the Radio Housing. (Figure C)

*Continue to final assembly.*

**A**

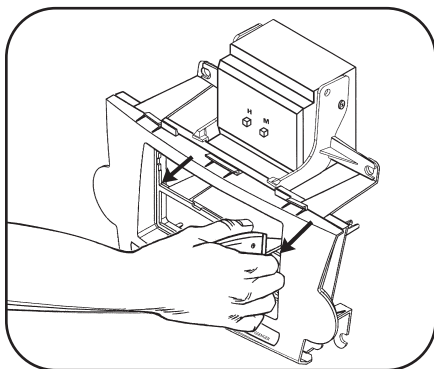

**B**

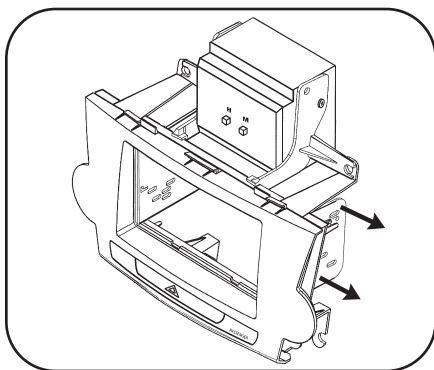

**C**

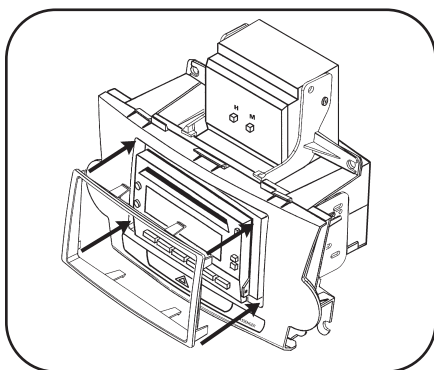





## NOTES

[illegible]

## NOTES

This image shows a single sheet of white paper with horizontal blue ruling lines. The lines are evenly spaced and run across the width of the page. There are no margins, text, or other markings on the paper.

