

## APPLICATIONS

Chrysler : Aspen 2008-09/Sebring 2007-09  
Town and Country 2008-09/300/300c 2008-09

Dodge: Avenger 2007-09/Caliber 2009/Challenger 2009  
Charger 2008-09/Dakota 2008-09/Durango 2008-09  
Grand Caravan 2008-09/Journey 2009\*  
Magnum 2008/ Nitro 2007-09/Ram 1500 2009

Jeep : Compass 2009/Commander 2008-09/Grand Cherokee 2008-09/Patriot 2009  
Liberty 2008-09/Wrangler 2007-09

Mitsubishi: Raider 2008

## CT24CH08

### KIT FEATURES

- DIN Mount Radio Provision with Pocket
- ISO Mount Radio Provision with Pocket

### KIT COMPONENTS

A) Radio Housing with Pocket • B) ISO Brackets • C) ISO Trim Plate

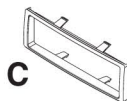
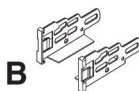
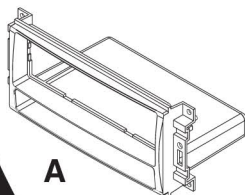

### TOOLS REQUIRED:

Small Flat Blade Screwdriver/ Panel Removal Tool  
• Phillips Screwdriver • Socket Set



# **TABLE OF CONTENTS**

## **Dash Disassembly**

- Chrysler Aspen 2008-2009/Dodge Durango 2008-2009 .....	1
- Chrysler Sebring 2007-2009 .....	2
- Chrysler Town and Country 2008-2009 .....	3,4
- Chrysler 300/300C 2008-2009 .....	5
- Dodge Avenger 2007-2009 .....	6
- Dodge Caliber 2009 .....	12
- Dodge Challenger 2009 .....	12
- Dodge Dakota 2008-2009 .....	7
- Dodge Grand Caravan 2008-2009 .....	3,4
- Dodge Magnum/Charger 2008.....	5
- Dodge Nitro 2007-2009/Liberty 2008-2009 .....	8
- Dodge Journey 2009 (Modifications to radio cavity required) .....	9
- Dodge Ram 1500 2009 .....	13,14
- Jeep Commander/Grand Cherokee 2008-2009 .....	10
- Jeep Compass 2009 .....	12
- Jeep Patriot 2009.....	12
- Jeep Wrangler 2007-2009 (Modifications to radio cavity required)...	11
- Mitsubishi Raider 2008 .....	7

## **Kit Assembly**

- DIN Mount Radio Provision with Pocket .....	15
- ISO Mount Radio Provision with Pocket .....	16

<b><u>Final Assembly</u></b> .....	17
------------------------------------	----

### **\*Note:**

**Refer also to the instructions included with the aftermarket radio.**

## **CHRYSLER ASPEN 2008-2009**

## **DODGE DURANGO 2008-2009**

- 1 Disconnect the negative battery terminal to prevent an accidental short circuit.
- 2 Unsnap and remove storage cup holder assembly. (Figure A)
- 3 Remove (2) screws from bottom edge of center dash trim panel. Unsnap and remove the panel. (Figure B)
- 4 Remove (4) screws securing the radio. Unplug and remove radio. (Figure C)

*Continue to kit assembly.*

**A**

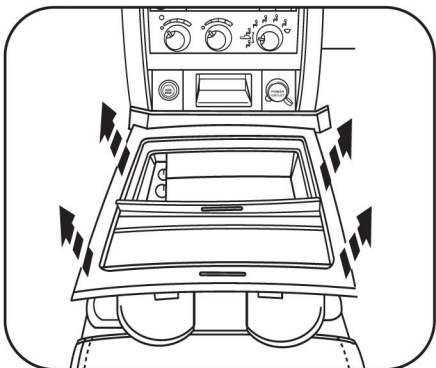

**B**

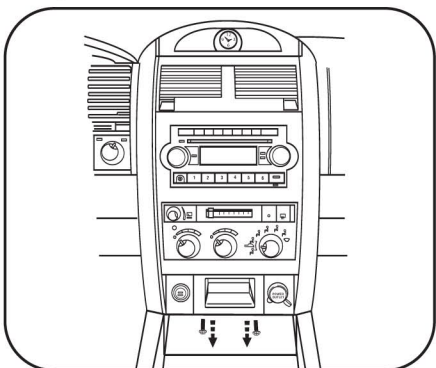

**C**

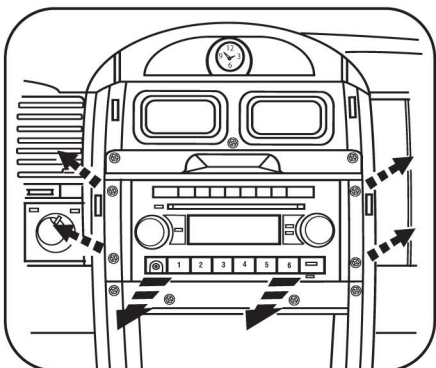

## **CHRYSLER SEBRING 2007-2009**

- 1** Disconnect the negative battery terminal to prevent an accidental short circuit.
- 2** Unclip entire panel surrounding radio including a/c vents and clock. Unplug and remove panel. (Figure A)
- 3** Remove (4) 7MM screws securing radio. Unplug and remove radio. (Figure B)

*Continue to kit assembly.*

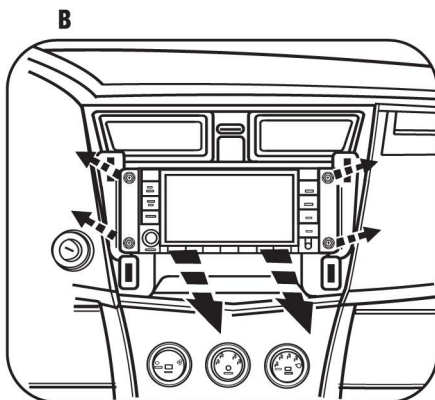
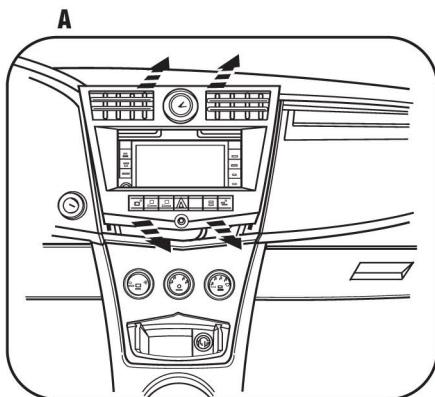

## **CHRYSLER TOWN AND COUNTRY 2008-2009**

### **DODGE GRAND CARAVAN 2008-2009**

- 1** Disconnect the negative battery terminal to prevent an accidental short circuit.
- 2** Remove (2) screw covers facing up above radio then remove the (2) Phillips screws exposed. (Figure A)
- 3** Lift up on panel above radio then remove (2) Phillips screws exposed at front edge of radio trim panel. (Figure B)
- 4** Remove (3) plastic push pins per side of bottom trim panel then slide panel toward rear of van to access (2) screws on bottom of radio trim panel. (Figure C)

*Continued on page 3.*

**A**

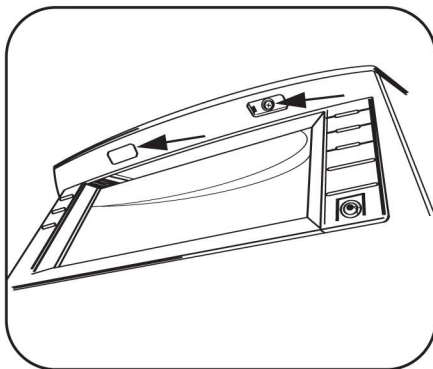

**B**



**C**

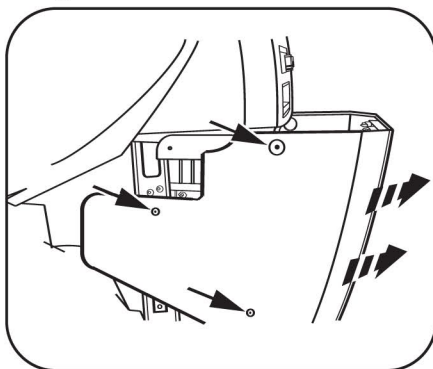

## **CHRYSLER TOWN AND COUNTRY 2008-2009** **DODGE GRAND CARAVAN 2008-2009**

- 5** Remove (2) Phillips screws exposed at bottom edge radio trim panel. (Figure D)
- 6** Unclip and remove entire panel surrounding radio including climate controls, vents and clock. (Figure E)
- 7** Remove (4) Phillips screws securing radio. (Figure F)

*Continue to kit assembly.*

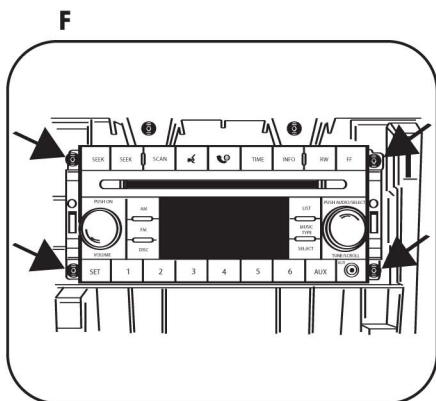
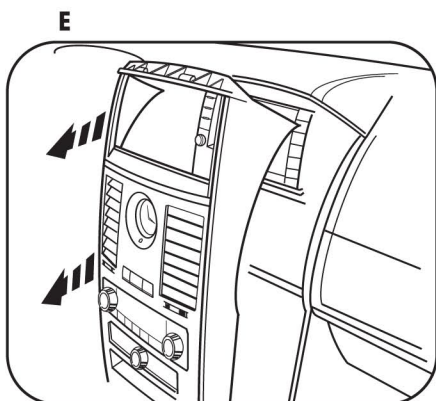
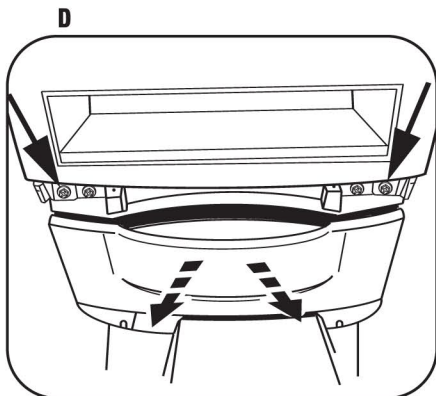

## **CHRYSLER 300/300C 2008-2009**

## **DODGE MAGNUM/CHARGER 2008**

- 1 Disconnect the negative battery terminal to prevent an accidental short circuit.
- 2 Unsnap and remove center dash trim panel. (Figure A)
- 3 Remove (4) screws securing the radio. Disconnect and remove the radio. (Figure B)

*Continue to kit assembly.*

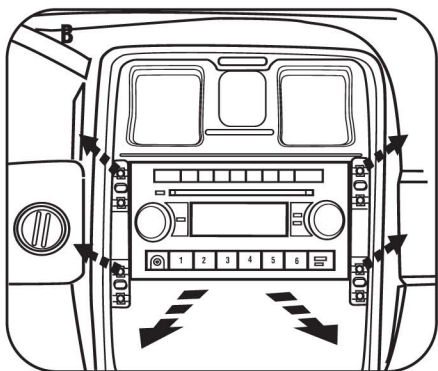
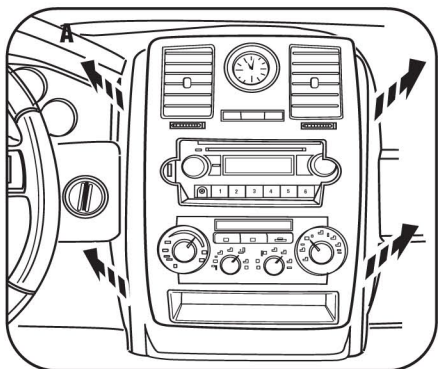



## **DODGE AVENGER 2007-2009**

- 1** Disconnect the negative battery terminal to prevent an accidental short circuit.
- 2** Unclip and remove the center console trim panel. (Figure A)
- 3** Unclip the center dash trim panel. (Figure B)
- 4** Remove (4) screws securing the radio. Disconnect and remove the radio. (Figure C)
- 5** Remove (3) screws securing the radio rear support bracket and remove the bracket. (Figure D)

*Continue to kit assembly.*

**A**

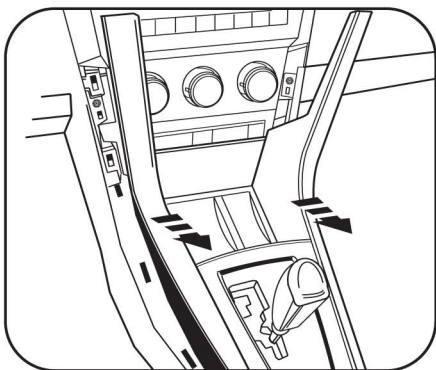

**B**

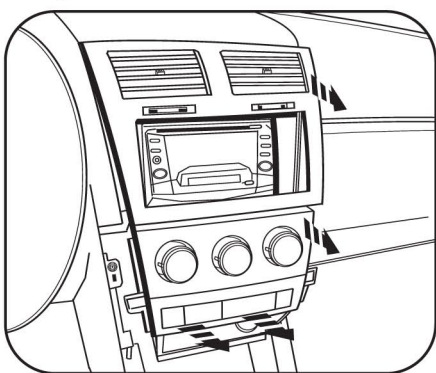

**C**

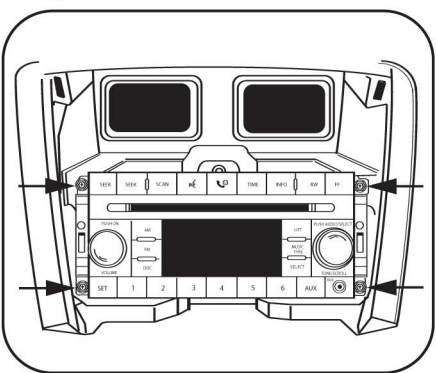

**D**

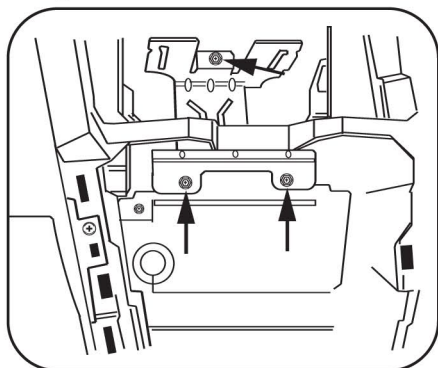



## **DODGE DAKOTA 2008-2009**

- 1 Disconnect the negative battery terminal to prevent an accidental short circuit.
- 2 Unclip and remove the trim panel surrounding the radio. (Figure A)
- 3 Remove (4) Phillips screws securing the radio. (Figure B)

*Continue to kit assembly.*

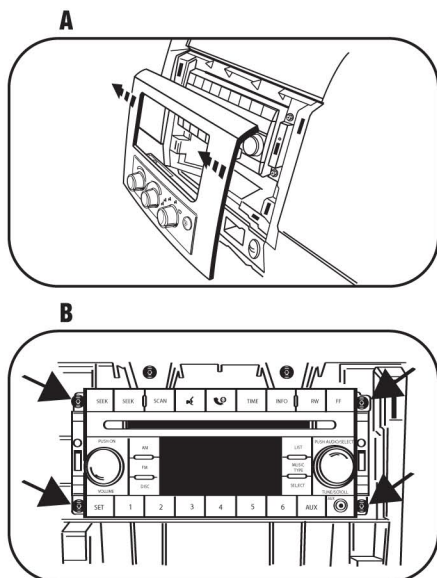

---

## **MITSUBISHI RAIDER 2008**

- 1 Disconnect the negative battery terminal to prevent an accidental short circuit.
- 2 Unsnap and remove center dash panel. (Figure A)
- 3 Remove (4) 7mm screws securing the radio. Unplug and remove radio.

*Continue to kit assembly.*

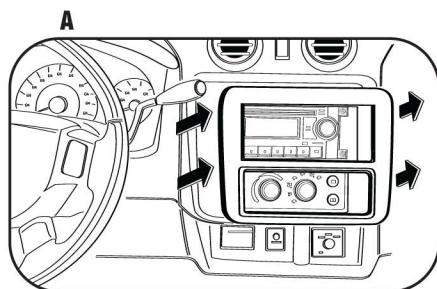

## **DODGE NITRO 2007-2009**

## **JEEP LIBERTY 2008-2009**

- 1** Disconnect the negative battery terminal to prevent an accidental short circuit.
- 2** Unclip entire panel surrounding radio and climate controls, including a/c vents. Unplug and remove panel. (Figure A)
- 3** Remove (4) 7MM screws securing radio. Unplug and remove radio. (Figure B)

*Continue to kit assembly.*

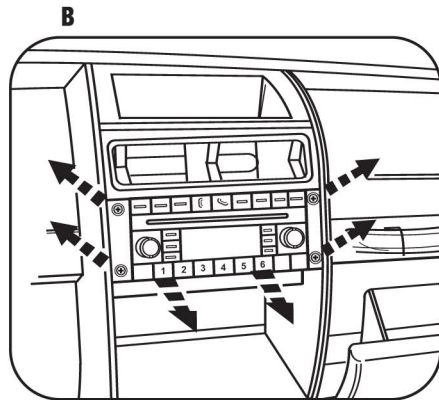
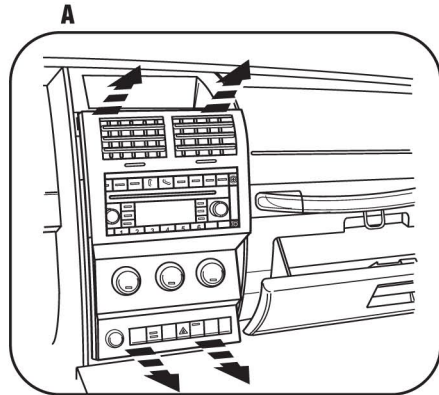

## **DODGE JOURNEY 2009**

- 1 Disconnect the negative battery terminal to prevent an accidental short circuit.
- 2 Unclip and remove the entire factory radio trim panel including the a/c controls. (Figure A)  
**TIP:** *Open the compartment door at the top of the radio trim panel.*
- 3 Remove (4) 7MM screws securing radio to dash to remove. (Figure B)

**NOTE:** *The top of the metal bracket in the sub dash will need to be cut to allow for the clearance of the Double DIN radio's chassis. (Figure C)*

*Continue to kit assembly.*

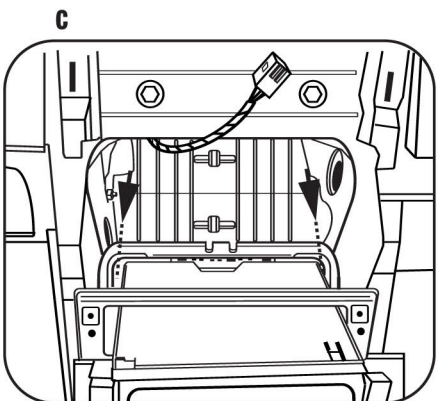
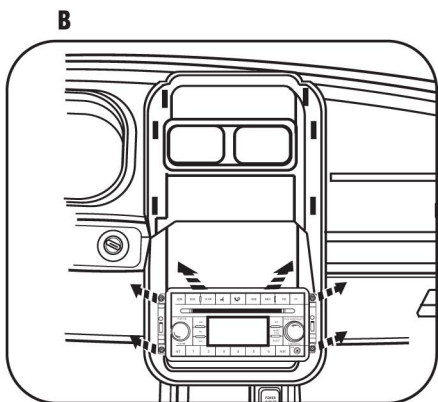
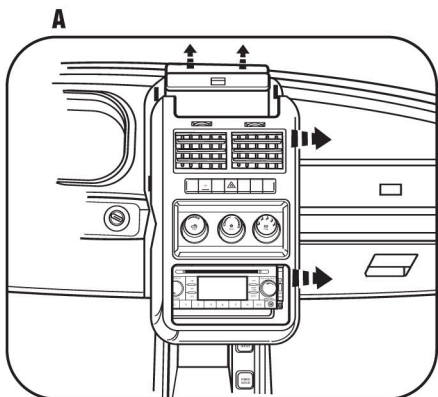

## **JEEP COMMANDER/GRAND CHEROKEE 2008-2009**

- 1 Disconnect the negative battery terminal to prevent an accidental short circuit.
- 2 Unsnap and remove the small trim around the console shifter. (Figure A)
- 3 Unsnap and remove the larger trim around the console shifter. (Figure B)
- 4 Remove one Phillips screw from inside the small storage pocket in the lower dash, between the power outlets. (Figure C)
- 5 Unsnap and remove the dash panel from around the radio (including climate controls). (Figure D)
- 6 Remove (4) Phillips screws securing the radio. Unplug and remove radio.

*Continue to kit assembly.*

**A**

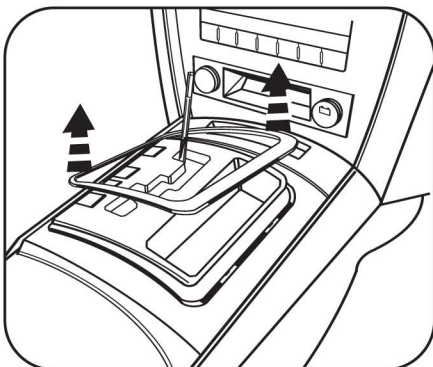

**B**

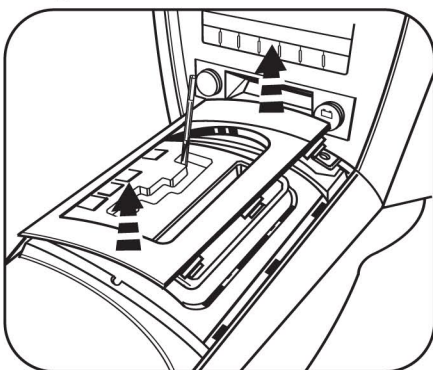

**D**

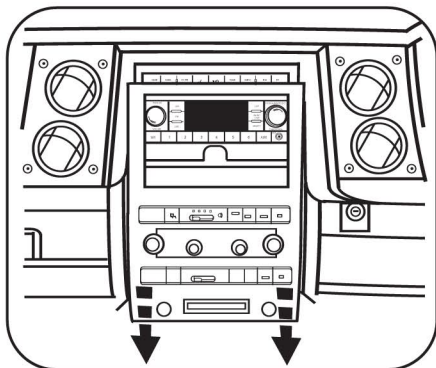

**C**

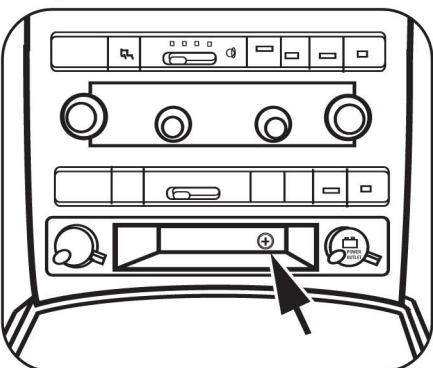

## **JEEP WRANGLER 2007-2009**

- 1** Disconnect the negative battery terminal to prevent an accidental short circuit.
- 2** Unclip and remove the lower center trim below a/c controls. (Figure A)
- 3** Remove (2) Phillips screws exposed behind lower center panel. (Figure A)
- 4** Unclip and remove the upper center trim starting towards the rear of the panel. (Figure A)
- 5** Remove (2) Phillips screws exposed behind upper center panel. (Figure A)
- 6** Unclip and remove entire panel surrounding radio and climate controls, including a/c vents.
- 7** Remove (4) 7MM screws securing radio. Unplug and remove radio. (Figure B)

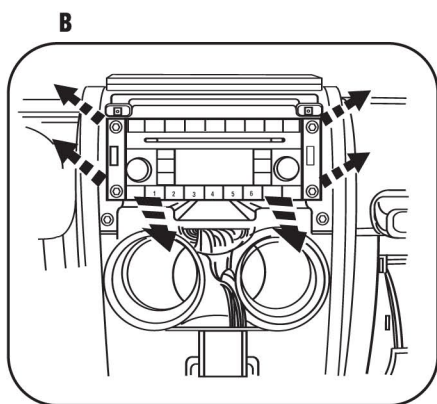
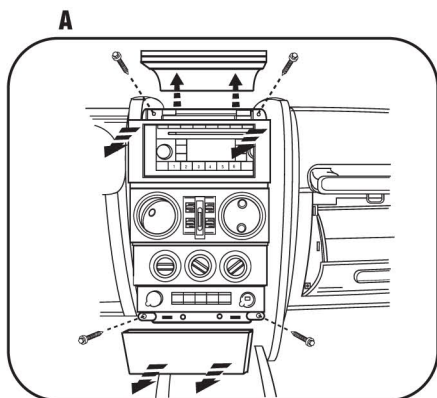

*Continue to kit assembly.*

**DODGE CALIBER 2009**  
**DODGE CHALLENGER 2009**  
**JEEP COMPASS 2009**  
**JEEP PATRIOT 2009**

- 1** Disconnect the negative battery terminal to prevent an accidental short circuit.
- 2** Unsnap and move shifter trim to the side. **(Figure A)**
- 3** Unsnap center dash trim panel (do not remove until climate controls are removed). **(Figure A)**
- 4** Remove (4) Phillips screws holding climate control panel to backside of the center dash panel.
- 5** Remove (4) 7MM screws securing radio. Unplug and remove radio.
- 6** The metal bracket in the sub-dash will need to be removed for the aftermarket Double DIN radio's depth.

*Continue to kit assembly.*

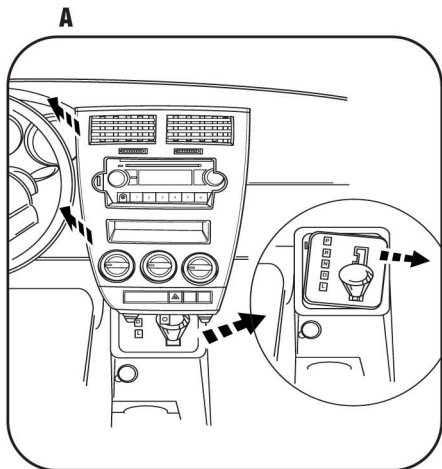

## **DODGE RAM 1500 2009**

- 1** Disconnect the negative battery terminal to prevent an accidental short circuit.
- 2** Remove (1) T25 Torx screw in the compartment next to the cup holders. (**Figure A**)
- 3** Remove (2) Phillips screws in the pocket below the climate control in the front of the center console. (**Figure B**)
- 4** Remove (2) 9/32" screws in the cup holders. (**Figure C**)
- 5** Push down on the collar below the shifter then pull the shifter straight up to remove. (**Figure D**)
- 6** Unclip and remove the top of the center console including the cup holders. (**Figure E**)

*Continued on page 14.*

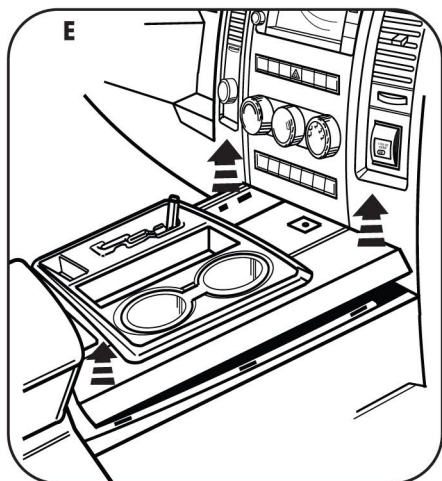
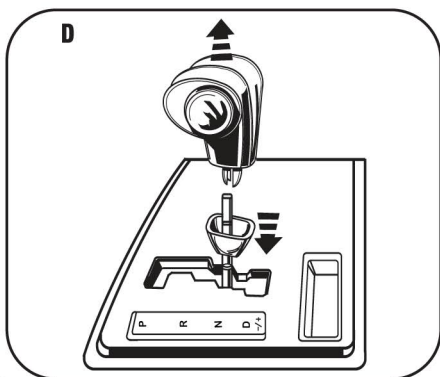
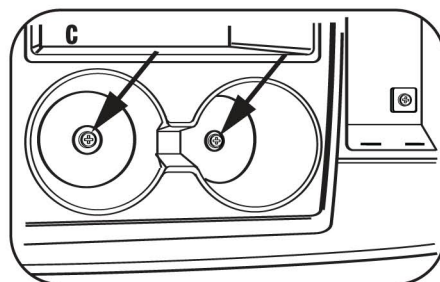
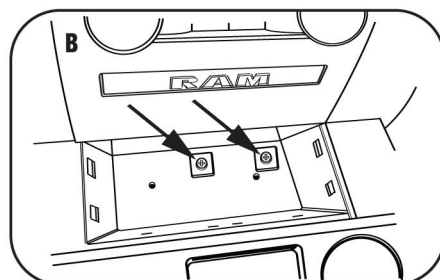
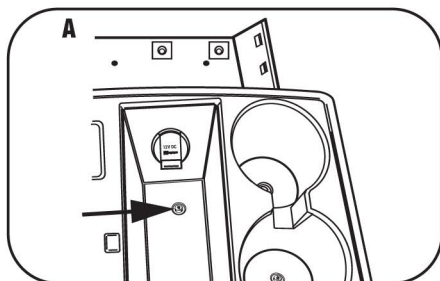



## **DODGE RAM 1500 2009**

- 7** Unclip and remove the trim panel from the accessory socket on the radio trim panel, then remove (1) T25 Torx screw. **(Figure F)**
- 8** Remove (2) T25 Torx screws from the top of the radio trim panel. **(Figure G)**
- 9** Unclip and remove the entire radio trim panel including the climate controls. **(Figure H)**
- 10** Remove (4) 9/32" screws securing the radio. **(Figure I)**

*Continue to kit assembly.*

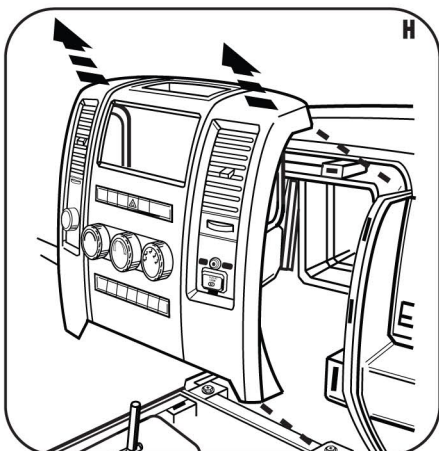
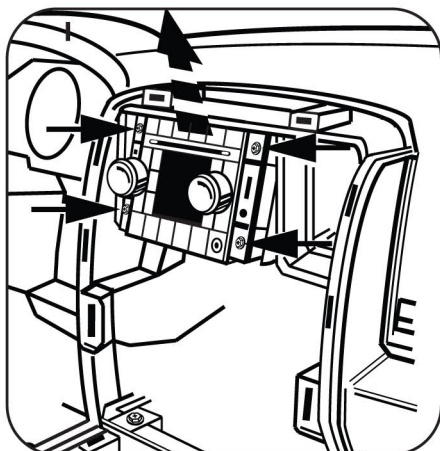
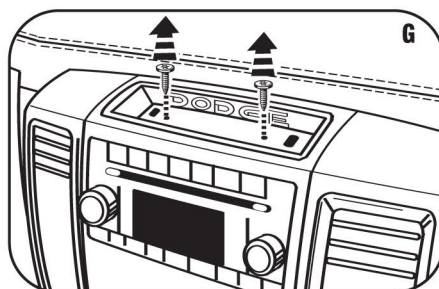
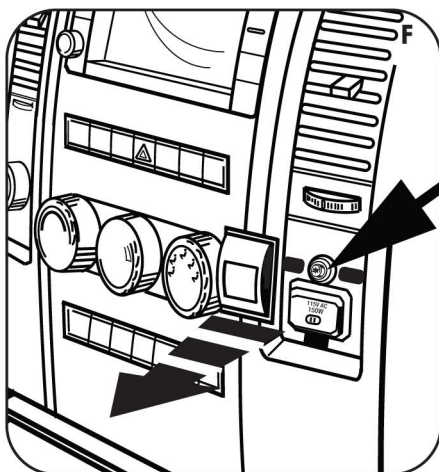

## DIN MOUNT RADIO PROVISION WITH POCKET

***\*Note:** Refer also to the instructions included with the aftermarket radio.*

- 1 Slide the DIN cage into the Radio Housing and secure by bending the metal locking tabs outward. (Figure A)
- 2 Slide the aftermarket radio into the DIN cage until it snaps into place. (Figure B)

*Continue to final assembly.*

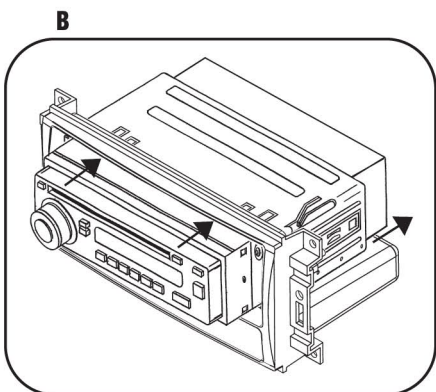
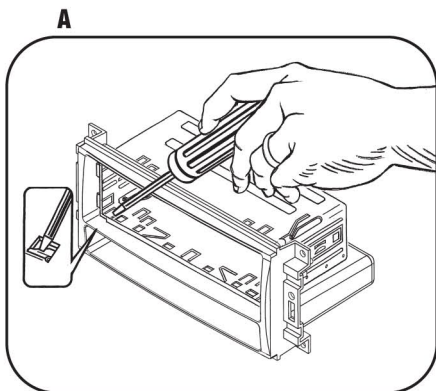

## ISO MOUNT RADIO PROVISION WITH POCKET

***\*Note: Refer also to the instructions included with the aftermarket radio.***

- 1** Mount the ISO Brackets to the radio using the screws supplied with the radio. (Figure A)
- 2** Slide the radio into the radio opening until it snaps into place. (Figure B)
- 3** Snap the ISO Trim Plate onto the front of the Radio Housing. (Figure B)

*Continue to final assembly.*

**A**

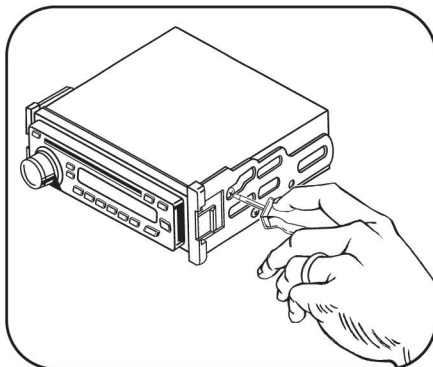

**B**

