

## IN-DASH STEREO INSTALLATION KIT FOR 2011-UP CHEVROLET CRUZE

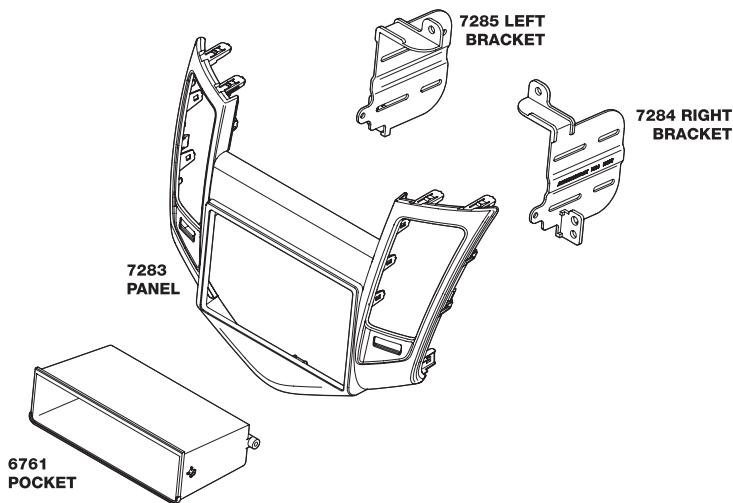

### INTRODUCTION/PRELIMINARY

This premium installation kit is for 2011-Up Chevrolet Cruze vehicles. Included are all the parts you need to mount your car stereo or CD player into your vehicle's dash. Refer to the individual instruction in this manual to remove your vehicle's factory radio and assemble the kit.

#### CAUTION

**DISCONNECT YOUR VEHICLE'S NEGATIVE BATTERY TERMINAL BEFORE THE INSTALLATION TO HELP PREVENT ELECTRICAL DAMAGE. WE RECOMMEND THE USE OF A VOLT/OHM METER OVER A TEST LIGHT TO CHECK WIRING. A TEST LIGHT OR GROUNDED WIRE PROBE CAN CAUSE DAMAGE TO THE VEHICLE'S COMPUTER AND/OR DIAGNOSTIC SYSTEMS. AVOID ALL FACTORY AIRBAG WIRING - AIRBAGS CAN ACCIDENTALLY DEPLOY CAUSING SERIOUS INJURY OR DEATH.**

#### NOTES

- See your vehicle's instructions for any special tools your installation might require.
- Read all instructions accompanying your car stereo for proper wiring and mounting instructions.

### CAR STEREO CONNECTORS

PROVIDE EASY CONNECTION OF YOUR CAR STEREO TO FACTORY WIRING HARNESS.

#### GM27SR

2011-Up Select GM Stereo Replacement Module

#### VWA3B

1997-Up Audi/1999-Up BMW/2002-Up VW Antenna Adapter

#### GM27SR



#### VWA3B



### LIABILITY DISCLAIMER

This instruction booklet is based on carefully documented data and research of automobile dash disassembly, wire harness/codes and information pertaining to installation of this kit (GM5202AB) in 2011-Up Chevrolet Cruze vehicles. Scosche Industries, Inc. cannot be held responsible for discrepancies/inconsistencies that may occur due to the automobile manufacturing changes or options, or damage that may occur in the automobile during the installation of components while using this booklet.

If you have any further questions, call our toll free technical help line at: **1-800-621-3695x3**

## FACTORY STEREO REMOVAL

### 2011-UP CHEVROLET CRUZE

1. Use a panel removal tool (PRT) to pop out the "U" shaped trim panel that surrounds the Gear shift and 2 climate controller knobs. Unplug and remove panel.
2. Use a Phillips head screwdriver and extract (2) 7mm hex screws from the storage pocket directly under climate control buttons. Remove pocket
3. Use a panel removal tool to pop out the "U" shaped vent panel surrounding the radio.
4. Extract (4) 7mm hex screws from the climate control sub-assembly. Use a PRT to release fasteners on the top of the assembly, unplug and remove.
5. Extract (2) 7mm hex screws from the factory OEM radio button control panel, unplug and remove.
6. Extract (2) 7mm hex screws from the factory OEM radio display sub-panel, unplug and remove.
7. Extract (2) 7mm hex screws from the factory OEM radio motor/chassis, unplug and remove.

## PANEL PREPARATION / CLIMATE ASSEMBLY MODIFICATION

In order to accommodate an aftermarket stereo chassis, the top edge of the Factory OEM climate control module must be slightly notched in (2) locations.

1. Use the illustration below as a guide and carefully make cutouts in the left and right upper edges of the factory assembly. Use a Dremel or a hand tool that will allow for precise clean plastic cuts.
2. Use a pick tool to unsnap and remove the (2) Factory air vent assemblies from the back of the Factory bezel and re-attach them to the back of the main GM5202AB kit panel.
3. Use a pick tool to remove (3) Factory snap clips from the lower edge radio trim bezel and re-attach them to the back of the GM5202AB kit panel.

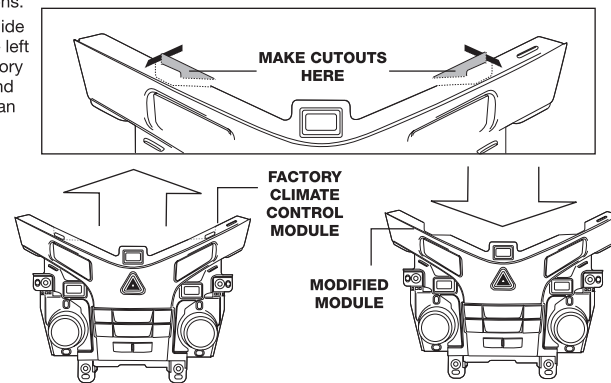

## STEREO ASSEMBLY / MOUNTING

### SINGLE DIN

1. Attach 6761 pocket to 7284 & 7285 brackets using supplied screws
2. Align and attach 7284 and 7285 brackets to aftermarket single din stereo using the screws supplied with the stereo.
3. Reconnect aftermarket stereo. Screw brackets and stereo assembly into dash opening. Finish reassembly.

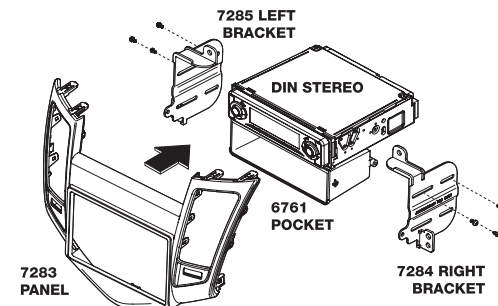

### DOUBLE DIN

1. Align and attach 7284 and 7285 brackets to aftermarket double din stereo using the screws supplied with the stereo.
2. Reconnect aftermarket stereo. Screw brackets and stereo assembly into dash opening. Finish reassembly.

